

# prac-tec®



**G-102 Gram Scale**

**USER GUIDE**

**GB**

Thanks for purchasing the G-102 Gram Scale!

This User Guide is designed to get you up and running quickly with your scale. Scales are precision instruments and require proper care and skill to get the best results.

## What's In The Box

User Guide



100g  
Calibration  
Weight



G-102  
Gram Scale



## Key Descriptions

**ON/OFF** - Turns the scale ON or OFF.

**MODE** - Changes the weighing unit.

**TARE** - Zeroes the scale. Also subtracts the weight of an empty container (see Tare Function).

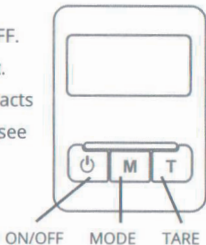

## Weighing Your First Item

1. Press the **ON/OFF** key to turn the scale on.
2. Place the item on the centre of the weighing platform.
3. Take your reading from the display. You can press the **MODE** key to convert between weighing units.
4. The scale's auto-off function will turn the scale off after 3 minutes of inactivity or you can press the **ON/OFF** key to turn the scale off.

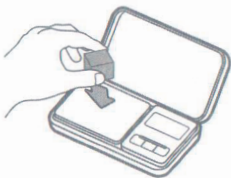

## Unhinging The Cover / Tray

1. Open the cover so it lays flat.
2. Slide the cover to the left.

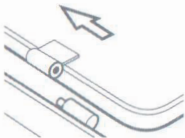

## Things To Avoid



Uneven Surfaces



Radio Frequency Interference



High Humidity



Air Currents



Vibration



Extreme Temps

## Tare Function

The Tare function allows you to subtract the weight of a container so that the display only shows the weight of the contents.



**NOTE:** The weight of the container will subtract from the available capacity and will leave a negative value on the display once the weight is removed. Press **TARE** again to return the display to zero.

## Auto-Off

By default, the scale will auto-off after 180 seconds of inactivity. To change or disable the auto-off timer:

1. Turn the scale on and wait for the display to zero.
2. Press and hold the **TARE** key until the display shows the current auto-off setting (eg 180), then release.
3. Press the **MODE** key to change the auto-off setting between 180 sec, 120 sec, 60 sec, or 0 sec (auto-off disabled).
4. Press **ON/OFF** to turn the scale off when finished.



## Accuracy

Your scale comes calibrated from the factory and most users won't need to calibrate their scale for a long time. You should check your scale's accuracy periodically using calibration weights and perform calibration if necessary. **NOTE:** Only use trusted calibration weights.

## Calibration

 Calibration is permanent and should only be performed using accurate calibration weights that match the requirements for your scale. Do not use coins or other household items to calibrate.

1. Prepare the required weight for your scale (see chart on back).
2. Find a flat and level surface to perform calibration and let the scale adjust to room temperature.
3. Press **ON/OFF** to turn the scale on and wait for the scale to stabilise.
4. Press and hold the **MODE** key until the display shows 'CAL'.
5. Make sure nothing is on the platform then press **MODE** to confirm the zero point.
6. The display will then flash the required calibration weight.
7. Place the required calibration weight on the centre of the platform.
8. The display will show 'PASS' then return to normal weighing mode. You may now turn the scale off or continue weighing.

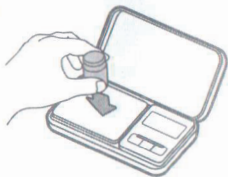

## Specifications

### G-102

<b>Max Capacity</b>	100.00 g / 500.00 ct
---------------------	----------------------

<b>Readability</b>	0.01 g / 0.05 ct
--------------------	------------------

<b>Weighing Units</b>	g, ct
-----------------------	-------

<b>Dimensions</b>	Overall: 142 mm x 85 mm x 24 mm Platform: 77 mm x 60 mm Display: 41 mm x 20 mm
-------------------	--

<b>Calibration Weight</b>	100g (Included)
---------------------------	-----------------

<b>Power</b>	2 x AAA Batteries (Not Included)
--------------	----------------------------------

<b>Warranty</b>	1 Year Limited
-----------------	----------------